



# India's no.1 leading manufacturer of shot blasting & Painting systems

A streamlined organizational structure along with a fully motivated team of "Krishna" make it possible to manufacture the blasting & painting systems with the same consistency of high quality at an economical price.



## Furniture Industry ADVANCE SURFACE **PREPARATION** TECHNOLOGY SINCE 2004

India's no. 1 Leading Brand in shot blasting & painting systems

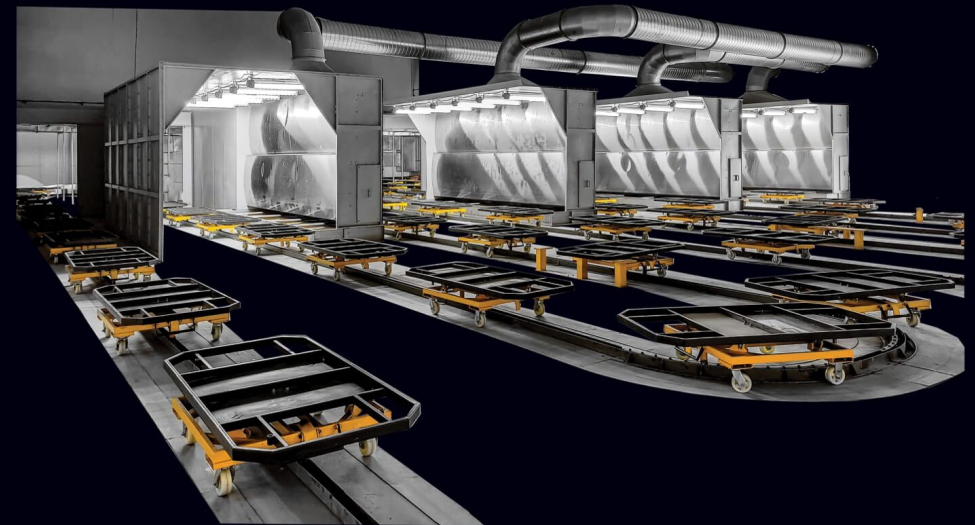

✉ email:  
info@krishnashot.com  
sales@krishnashot.com

🌐 website:  
www.krishnashot.com

📞 contact:  
+91 9358839271, +91 8094000875,  
+91 9928042727, +91 9772458104

pune indore delhi hyderabad jaipur kolkata chennai ahmedabad

www.krishnashot.com



# WELCOME TO KRISHNA SHOT BLASTING & PAINTING SYSTEMS

INDIA'S LEADING MANUFACTURER OF SHOT BLASTING & PAINTING SYSTEMS

Krishna Shot is a fast-growing company in India, specializing in the manufacturing of shot blasting and painting booth systems, powder coating, and dust collectors.

## SINCE 2004

KRISHNA SHOT we are the vanguard of technical ingenuity and craftsmanship in the realm of shot blasting and painting booths.

Technical Mastery Beyond Compare Our engineering team is an unparalleled force, a collective of individuals whose expertise transcends the conventional boundaries of technical proficiency. Armed with over 18 years of specialized knowledge in the intricate Manufacturing & Redeveloping design of shot blasting machines, shot blasting rooms, and paint spray booths, and further bolstered by an impressive track record of over 18 years in the hands-on manufacturing of these systems, we stand as the epitome of technical excellence.

Precision Engineered to Perfection Precision isn't just a word in our vocabulary; it's the cornerstone of everything we do. From the inception of a concept to the meticulous design of each component, from the precision-driven manufacturing process to the intricate installation of our solutions, our unyielding commitment to engineering perfection knows no bounds. Our highly skilled team is not just a workforce; they are artisans in the craft, orchestrating every facet of production, installation, commissioning, and servicing with an unwavering dedication to the art of precision engineering.

Embark on a Technical Odyssey We extend an invitation to immerse yourself in the world of technical prowess through our comprehensive product catalogue, thoughtfully included herein. Within its pages, you will encounter a showcase of our cutting-edge shot blasting machines, intricately designed shot blasting rooms, and state-of-the-art paint spray booths. This catalogue stands as a testament to our relentless commitment to pushing the envelope of precision engineering.

Choose KRISHNA-SHOT for Technical Excellence When you choose KRISHNA-SHOT, you are choosing not just a partner but a connoisseur in the art of precision engineering. Our multifaceted portfolio of precision-crafted equipment is not designed to merely meet your technical expectations; it's engineered to far exceed them. Forge a partnership with us, and together, we will venture into uncharted territories of technical excellence.

Experience the KRISHNA-SHOT difference, where technical engineering reaches its zenith. Contact us today to embark on a technical odyssey in the world of shot blasting and painting booths, and witness the symphony of technical brilliance.



### OUR VISION

To grow into Business Power-House that runs on the shared vision of Innovation & customer satisfaction.



**18+**  
Years  
Experience

Krishna Shot Blasting (I) Pvt. Ltd. was established in 2004 by our honorable founder Mr. Badri Malviya. KSB has always operated on 4 strong pillars of Trust, Honesty, Innovation and Quality



### OUR MISSION

To design, Manufacture and Service of Sand/Shot blasting solutions for our customers that will help shape the future of Surface Finishing industry, both in India and Internationally.



**3**  
Manufacturing  
plants

Machines of world class quality and the highest selling brand in the sector, KSB Paint Booth is the first Machinery to be manufactured in-house



### OUR VALUES

- \* Trust
- \* Honesty
- \* Innovation
- \* Quality



**350+**  
Well qualified trained & skilled work force

KSB is pioneer in bringing corporate culture to Shot-Sand Blast Industry. A benchmark for others to follow. Goal : Customer Satisfaction.



**12000+**  
Installations

Guidance for suitable solution Team of experts engage with you to understand your need & guide you in selection Live Demo & training is on offer.



**70+**  
On-field service engineers

Dedicated customer care, Region wise Service teams, at your service. KSB has highest number of service engineers in the field. Also on call, for telephonic guidance



**Spares**

Availability at reasonable cost  
Spare-parts are crucial in any machinery. We maintain huge stock of all standard spare parts for immediate replacement.



**700+**  
Machines mfg. per annum

More than 3 lakh sqft of manufacturing floor. A truly automated facility with systems and equipments for world class manufacturing.



**Total Customer Satisfaction**

Quality + Best Deals + On-time service ensure most satisfied customers. Thousands of satisfied customers, make KSB the 1st choice in the industry.



**15+**  
Countries

KSB has world-class offices in major cities. In essence, KSB machines are installed in various countries.



**service**  
Customer Care  
+91 97724 58104  
+91 97724 58104  
+91 93588 39271



**spares**  
+91 97724 58104  
+91 88249 76105



**support**  
info@krishnashot.com  
sales@krishnashot.com  
marketing@krishnashot.com

- \* Online technical assistance
- \* Training sessions
- \* Dedicated Service Team of 70+ engineers across India
- \* Spare availability at reasonable price

# CART CONVEYOR FINISHING LINE SYSTEM

Cart conveyors can be used in a wide variety of applications where it is advantageous to carry products on mobile carts. Some products are considered "unconveyable" due to their shape, configuration or size. A typical example would be large four-legged furniture items.

KRISHNA SHOT BLASTING utilizes mobile carts, normally with a rotating top, onto which the item to be conveyed is placed. A variety of floor-mounted conveyors are used to propel the cart through the process, depending on the loading, speed and preferred configuration.

KRISHNA SHOT Conveyor system can be designed with on-floor or in-floor tracks. On-floor conveyors are attached to the floor surface without trenching. In this case, plant personnel must walk over the track, and forklifts cannot drive in the area of the conveyor. The drive unit may be situated in a "pit" or mounted above the floor, provisions must be made where the cart crosses over the drive unit.

#### Other features of the KRISHNA - SHOT cart Conveyor system:

- \* Standard 4-wheeled cart is propelled by a drive chain.
- \* Towline track can be in-floor or on-floor mounted with minimal cross section height.
- \* Top platens can be custom designed based on size, shape and weight of the item being conveyed.
- \* Platens can be rotated manually or automatically for close packing.
- \* Reliable conveyor chain used with ball bearing wheels instead of "link" chain to reduce maintenance.

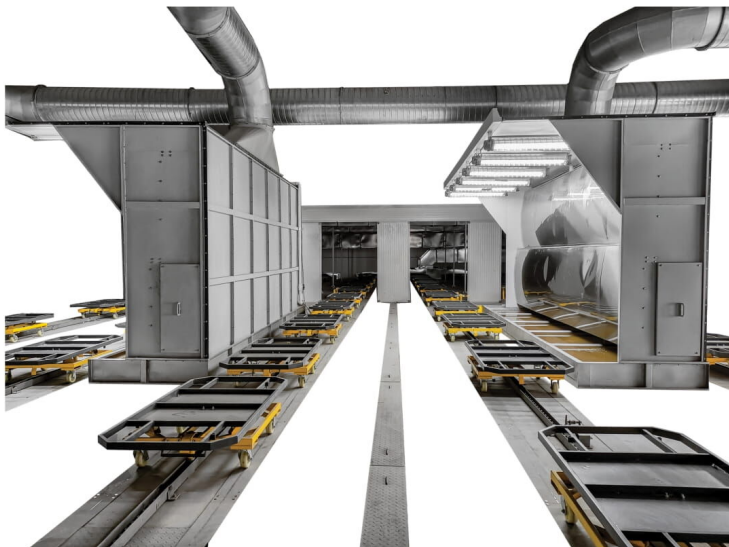

# OUR NEW TURNKEY PROJECT CART CONVEYOR CONCEPT DRAWING

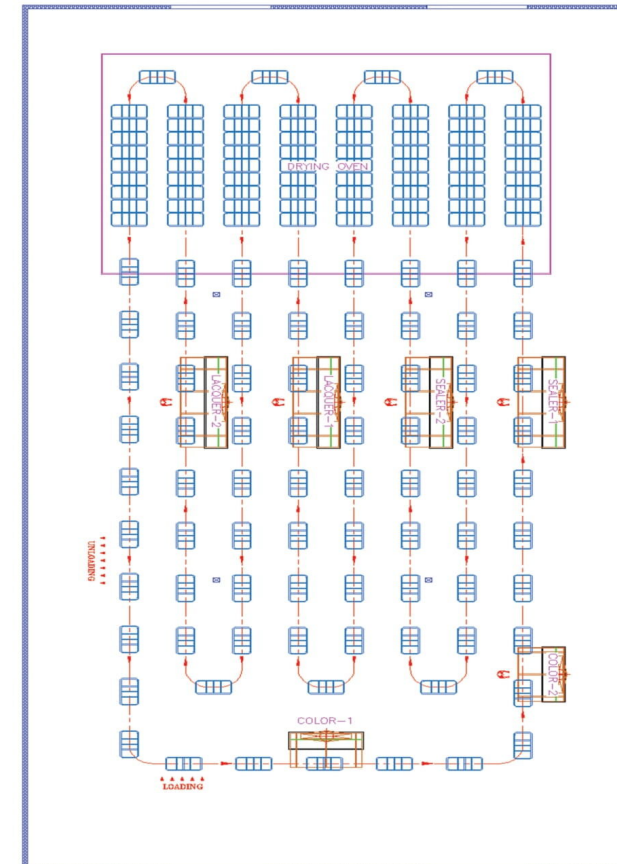

CART CONVEYOR  
WATER CURTAIN BOOTH



CART CONVEYOR  
DRYING OVEN

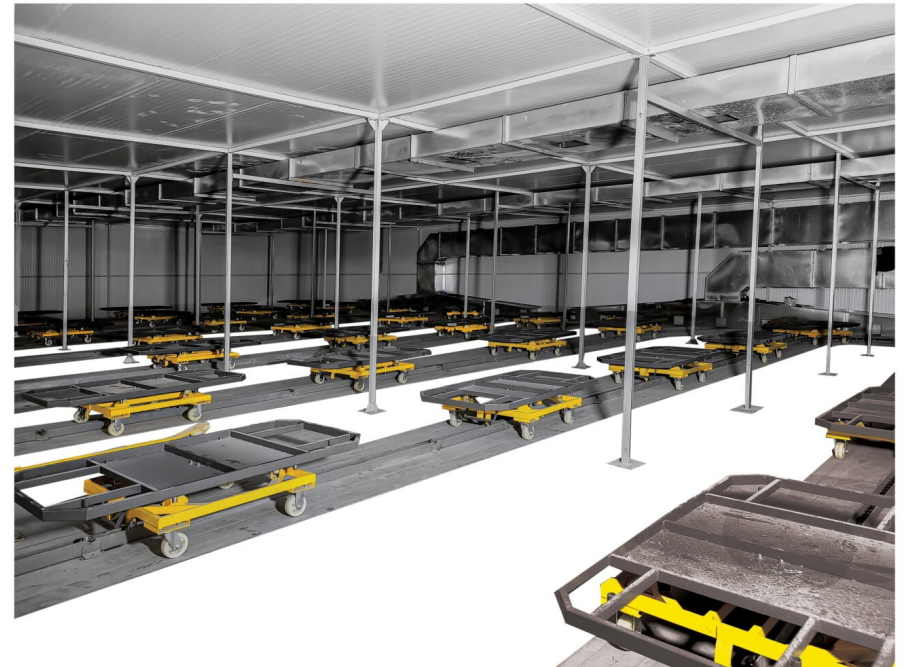

# CART CONVEYOR EXHAUST DUCT



# HORIZONTAL FINISHING LINE SYSTEM

Surface finishing Line is a broad range of industrial processes that alter the surface of a manufactured item to achieve a certain property.

[1] Finishing processes may be employed to: improve appearance, adhesion or wettability, solderability, corrosion resistance, tarnish resistance, chemical resistance, wear resistance, hardness, modify electrical conductivity, remove burrs and other surface flaws, and control the surface friction.

[2] In limited cases some of these techniques can be used to restore original dimensions to salvage or repair an item. An unfinished surface is often called mill finish.

Surface finishing processes can be categorized by how they affect the workpiece:

Removing or reshaping finishing Adding or altering finishing Mechanical processes may also be categorized together because of similarities the final surface finish.



HORIZONTAL  
FINISHING LINE  
DRYING OVEN



HORIZONTAL  
FINISHING LINE  
WATER CURTAIN  
BOOTH



# HORIZONTAL FINISHING LINE IDLER ROLLER CONVEYOR



# CENTRALIZED SANDING WALL

Krishna Shot Blasting manufactures both Single Side Open and Both Side Open Sanding Wall Systems. Krishna's Sanding Wall System has an inbuilt dust collector to blow-in the dust particles coming from machining work inside the Sanding Wall.

- Our Sanding Wall System categories:
1. Single Side Open Sanding Wall System
  2. Both Side Open Sanding Wall System

S.No.	Model (WxDxH)	SANDER CAPACITY	COMPRESSED AIR REQUIREMENTS FOR BAG CLEANING	POWER REQUIREMENTS
1	KSB-SB-10x6x8	2 NOS.	5 CFM@ 80 PSI	10 HP
2	KSB-SB-20x6x8	4 NOS.	10 CFM@ 80 PSI	20 HP



# DRY PAINT SPRAY BOOTH

Dry type Spray booths are designed to collect particulate emissions. Filtration media, such as filter pads and moving air are the primary tools in this collection. Coating material applied by a spray gun or similar device with human or robotic assistance. The air stream moving through the booth collects the solids and transports them to the filtration medium. Three elements force and direction of the air, the efficiency of the filtration, and the characteristics of the coating equipment- determine the overall efficiency of the coating operation and the quality of the finish.

S.No.	Model (WxDxH)	FILTERS	POWER CONSUMPTION
1	DPSB-10X7X7	6 NOs.	5 HP
2	DPSB-20X7X7	10 NOs.	10 HP

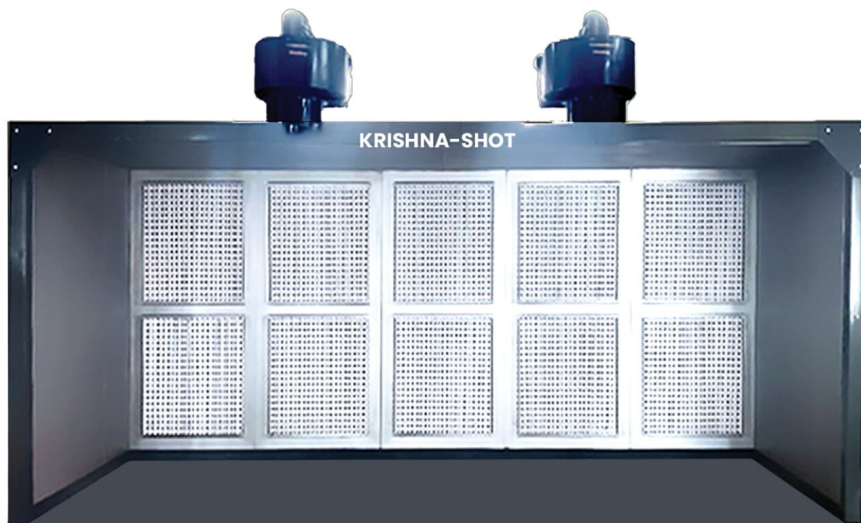

# WATER CURTAIN PAINT SPRAY BOOTH

The WATER CURTAIN BOOTH provides an extremely efficient means of removing paint particles from the exhausted air by using water as a filtration media, have designed the WATER CURTAIN PAINTING BOOTHS for many finishing applications. Water Curtain Paint Spray Booth open fronted spray booths is modular in construction, manufactured from galvanized steel folded panels. The width and height of the Water Curtain Paint Spray Booth are selected by our engineers based upon specific site conditions and can be tailored to suit the application.

S.No.	Model (WxDxH)	WATER CAPACITY	POWER CONSUMPTION
1	WPSB-10X8X8	1000 LTR	6 HP
2	WPSB-20X8X8	2000 LTR	12 HP



# POWDER COATING OVEN WITHOUT TROLLEY

Powder coating is a type of coating that is applied as a free-flowing, dry powder. Unlike conventional liquid paint which is delivered via an evaporating solvent, powder coating is typically applied electrostatically and then cured under heat or with ultraviolet light.

**Accessories:**

- \* Baking oven(LPG / Electric) with dual Trolley system
- \* Powder coating booth
- \* Powder coating Gun



# POWDER COATING OVEN WITH TROLLEY



# CENTRALISED DUST COLLECTOR

Choice of the correct model of dust collector is integral to any closed environment blasting system. It is very essential to remove dust and fine abrasive particles from the environment of the blast chamber to maintain the efficient operation.

- Cyclone Type Dust Collector
- Pulse Jet Non Woven Type Dust Collector
- Pleated Filter Type Dust Collector
- Cartridge Filter Dust Collector



# DUST COLLECTOR DUCT

The dust collection ductwork is the hose and wand that draws the dust away from the machine creating pollutants. And the dust collector is the vacuum cleaner filtering dust and returning clean air either to the building or outside. Dust collection: Enhances worker safety, providing a cleaner, healthier work environment.



# DUST COLLECTOR ROTARY VALVE

The Dust Collector rotary airlock can be used for low-temperature minimal pressure differential, dust applications that are not meant to feed product but instead act as an air seal.



# ENCLOSURE TYPE SAND BLASTING

An enclosure or containment system, usually the room itself, designed to remain sealed to prevent blast media from escaping. Blast room is used in a wide variety of industries that require surface preparation prior to the application of a protective coating. The surface of the work piece is cleaned by a mixture of abrasive and high pressure compressed air being directed by blast nozzle. The blast room contains the abrasive being shot at the work piece, as well providing lighting and ventilation for operator's safety.



# ELECTRIC CONTROL PANEL

The electrical control panel is a well-built metallic structure that houses a circuit breaker to control power supply, transformers for voltage leveling according to requirement, terminal blocks for housing different voltage level lines, PLCs for logical operation and automation, relays for control over connection.

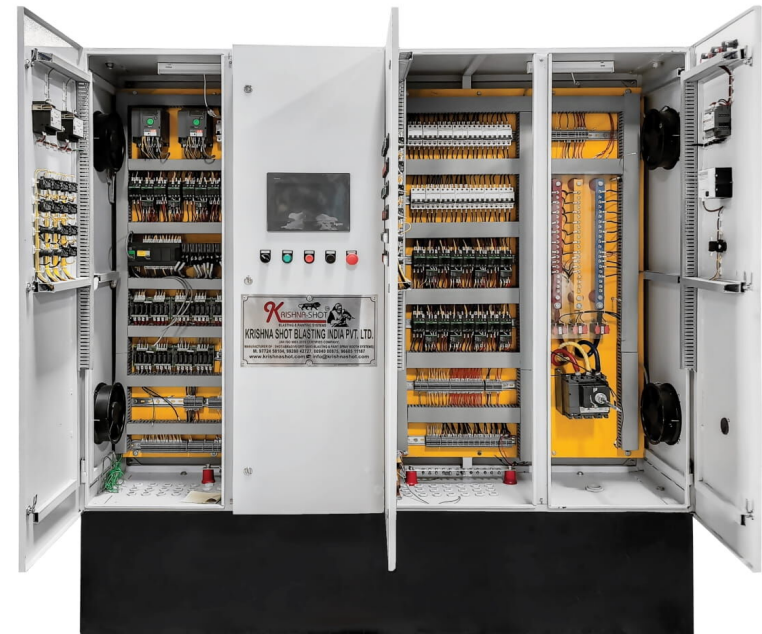

# CONTINUE CONVEYOR TYPE SHOT BLASTING MACHINE

It is a kind of Airless kind completely automated shot blasting machine. It is essential to know that our Hanger Blast Shot Blasting Machine is entirely based on the wheel blasting concept.

Krishna shot ensures that the rotating spinner is placed within the chamber in this kind of machine. It is the right place where the blasting occurs. Based on the desired output and size of the job.



# SPINNING HANGER



BEFORE BLASTING



AFTER BLASTING

# DOOR MOUNTED SHOT BLASTING MACHINE

It is a Airless Machine completely automated type shot blasting TYPE machine. It is essential to know that MACHINE our Hanger Type Shot Blasting Machine is entirely based on the wheel blasting concept. It is can be customized based on customer's needs. Hanger Type Blast Shot Blasting Machine offers the best kinds of categories which are useful for customers.



# BELT CONVEYOR SAND BLASTING MACHINE

It has multiple Blast Wheel Stations for throwing Shots on the Stone Slab to be finished or textured. Certain blast wheels are largely designed for stone finishing and texturing applications. The stone slabs are moved on the specific conveyor of the stone blasting machine.



# CONTINUOUS OVERHEAD CONVEYOR FINISHING LINE PLANT

Powder coating is a type of coating that is applied as a free-flowing, dry powder. Unlike conventional liquid paint which is delivered via an evaporating solvent, powder coating is typically applied electrostatically and then cured under heat or with ultraviolet light.



# PORTABLE BLASTER

KRISHNA SHOT Portable Blaster is safe, high productivity and long life wear and tear parts as compare to others. The portable abrasive blaster works on 'Direct Pressure System' resulting in very high cleaning rate and more economical system by Manual blasting, it's manufactured as per IS-2825 and hydraulically tested for 250 psi.

## SPECIFICATION FOR STANDARD MODELS:

S.No.	DESCRIPTION / MODEL	KSB - P7 - 150	KSB - P7 - 301/R	KSB - P7- 501/R	KSB - P7 - 1001/R
1	Tank Capacity In (Cft),Metallic Girt In (kg)	15 , 150	3 , 300	5 , 500	10 , 1000
2	Machine dimension-Dia (mm),Height (mm)	360 , 1100	365 , 1300	610 , 1400	760 , 1600
3	Selection Criteria On Production Rate Sq Mtr/Hr	3-4	4-7	9-12	15-20
4	Blast Nozzle Size (mm)	5-0	6-0	8-0	*10/12
5	Blasting Hose Size (mm),Length-Meter	19 , 5.0	19 , 5.0	25 , 7.5	32 , 10
6	Compressed Air Required at 80 Psi (CFM)	45	70	135	240
7	Compressor Requirement (HP)	15	25	40	75
8	Recommend Grit Size-Bs Mesh	35 to 80	25 to 80	16 to 80	12 to 80
9	Empty Machine Approx Weight-Kg	95	150	190	250

